



Prairie 1 Farm
Tumey, Brian - NRCS, Algona, IA
To: jfranzen@farmersnational.com

01/21/2021 09:18 AM

1 attachment



tile.pdf

Good Morning Jim,

Attached is some tile information I found in our files here at the office. Unfortunately whoever filled out the information did not do a good job of drawing on the maps to show the tile, if they did at all. I attached a map showing where the tile should be for the terraces, especially on the east side of the farm. As far as other information for the farm, there is no conservation plan on file and the terraces have met their lifespan as far as a maintenance agreement goes for them. The tract does have a Prior Converted/Non-Wetland (PC/NW) determination on file so no wetland issues out there.

Let me know if you have any questions. Have a good one!

Brian

Brian Tumey
District Conservationist
605 E. State St. Suite 2
Algona, IA 50511
Natural Resources Conservation Service
United States Department of Agriculture
<https://us-east-2.protection.sophos.com?d=usda.gov&u=aHR0cDovL3d3dy5pYS5ucmNzLnVzZGEuZ292&i=NWVjN2Q4MzUxNjk2OGExNmY5ZDUzZGU1&t=WDI3Y202ZEFYjVIUnBHbERSaVhWSDBweTZvYTF2Zkt5OGJjTnJNaWJBdz0=&h=f2b18aad2bfa45e387cbadbed41ed655>
(515) 295-5156 ext 3 (office)
(515) 829-1431 (cell)

This electronic message contains information generated by the USDA solely for the intended recipients. Any unauthorized interception of this message or the use or disclosure of the information it contains may violate the law and subject the violator to civil or criminal penalties. If you believe you have received this message in error, please notify the sender and delete the email immediately.

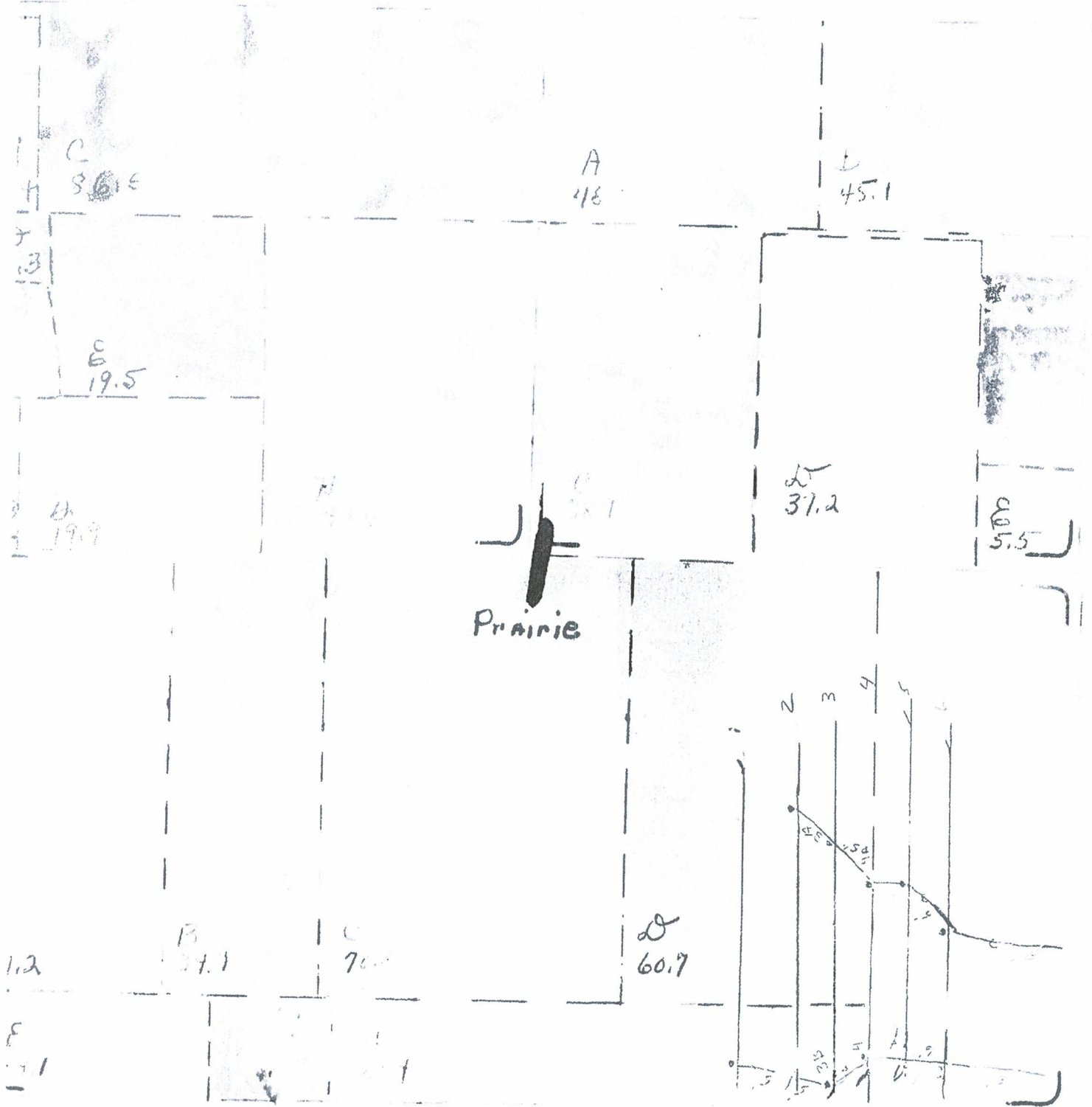

Kossuth Crop Year

G 13

70